



A UTC Fire & Security Company

## ADVANCE RFID Contactless Electronic Lock

ADVANCE RFID (Radio Frequency Identification) combines the extensive benefits of the Onity design centric ADVANCE lock with industry-standard contactless RFID technology.

- ❑ RFID Reader: Contactless Proximity Type Reader compatible with MiFare® (ISO14443A and ISO14443B part 4).
- ❑ Opening devices: Multi-segment ISO compliant keycard, wristbands, lanyards and other devices. Compatible with ISO MiFare® Ultra Light, 1K, 4K memory sizes and application segment configurations.
- ❑ Security: Devices are encrypted with the NXP Crypto-1 encoding algorithm and memory segment is secured using site code or similar security key.
- ❑ Detect/Read Range: 0 to 2 cm. Tag read cycle does not exceed 1 second including unlocking.

### Electronic Features

- ❑ Lock Audit Trail: Non-volatile memory records the last 500 lock openings including date, time and card used. Removal of batteries does not cause any loss of events.
- ❑ “Do-Not-Disturb” Function: Deadbolt operated by a thumbturn inside the room for added guest privacy and security.
- ❑ Programmable for length of time door remains open, and automatic closing.
- ❑ Each new guest card overrides any previous ones preventing re-entry.
- ❑ Low battery indicator lights alert hotel staff without disturbing guests.
- ❑ Programmable “office-mode” function (free passage).
- ❑ Full Masterkeying capabilities.
- ❑ Low consumption clock/calendar to control card shifts.

### Upgradeability

Upgrading to ADVANCE RFID from the magstripe/dual version is as simple as replacing the reader.

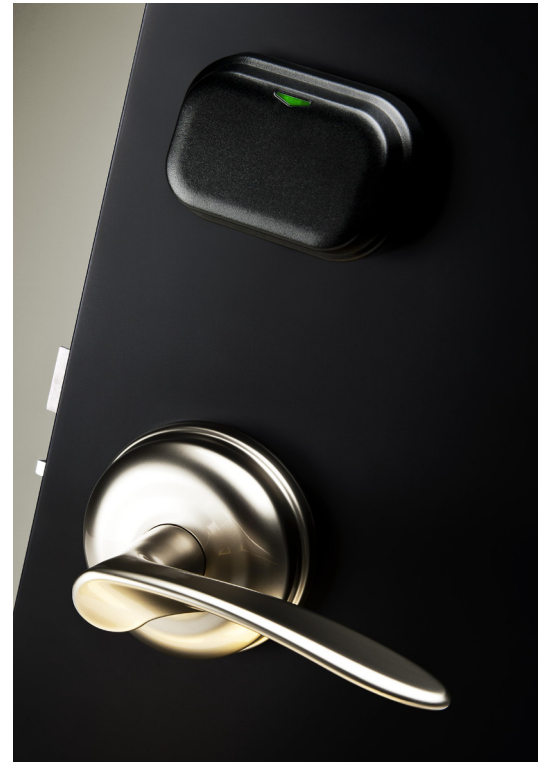
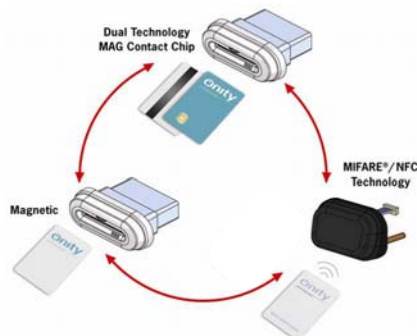

### Physical Features

- ❑ Off-line installation (no wires required).
- ❑ Fits most types of doors.
- ❑ Finishes: All Onity standard (Satin Chrome, Satin Brass) and special finishes (Polished Brass, Antique Brass, Polished Chrome, Satin Nickel, Dark Bronze and Gold).
- ❑ Levers: Wing, Toledo and Granada.
- ❑ Latch Mechanisms: EURO with Auto Latch, ANSI, ANSI with Auto Deadbolt, Cylindrical BLA and DIN.
- ❑ Concealed screw design.
- ❑ Batteries: 4 x standard AA.
- ❑ Attractive cover plates are available for retrofit projects.

### Certifications and Standards

- ❑ European Fire Certification EN 1634-1
- ❑ FCC & CE certified
- ❑ UL10C certified for 3 hours
- ❑ BHMA 156.25 & BHMA 156.13

## ADVANCE RFID Contactless Electronic Lock

### Dimensions (mm)



EURO

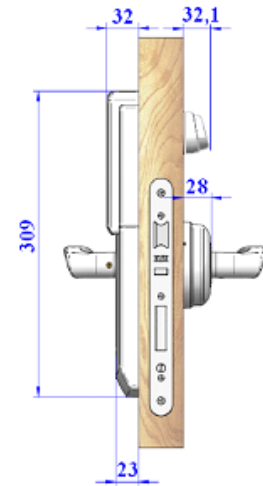

ANSI

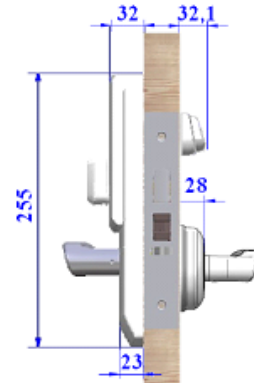
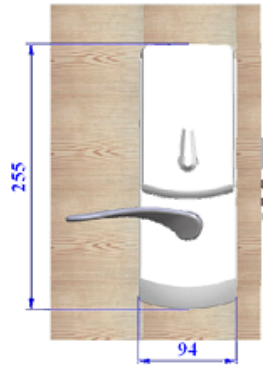

Tubular  
BLA

